

Installation Instructions / Warranty

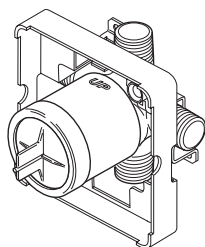

Commercial
06348000

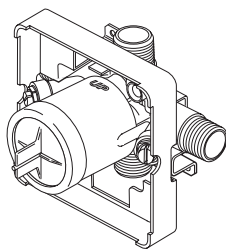

Commercial
06349000

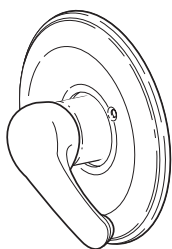

Commercial
06335000

hansgrohe

Pressure Balance Valve

06348000

Pressure Balance Valve with Stops

06349000

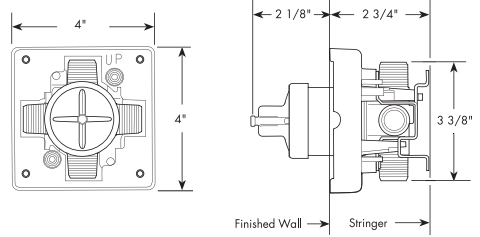

06348000

Product Specification

brass valve body

anti-scald - maintains desired temperature

+/- 3°F

1/2" male threaded inlets

reversible cartridge - allows use in back-to-back installation

Flow rate: 4.25 gpm@ 45psi

Incorporates rotational limit stop, which may be re-set to comply with local plumbing codes

To prevent damage or loss on the jobsite, the cartridge is included with the trim kit.

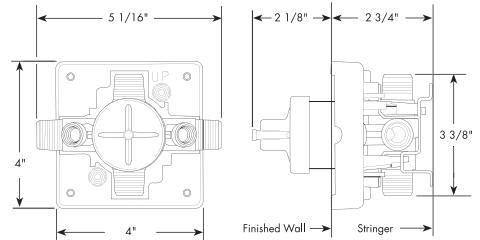

06349000

Installation considerations:

Make sure you know what kind of wall is to be installed, so that the required stringer may be installed at the proper location. See page 3.

Read the instructions for the shower arm and tub spout prior to rough-in to see if there are any special installation requirements.

The bottom outlet is to be plugged or to be used for a diverter tub spout only.

Piping between the valve body and tub spout must be a straight drop of 1/2" iron pipe or copper tube between 8" and 18". There should be only one 90° elbow to the tub spout nipple. Do not use PEX for the tub spout drop, or stacking may result.

Suggested Installations

- Stationary showerhead
- Handshower
- Tub/shower with stationary showerhead and diverter tub spout

Preparation for installation:

Install a stringer in the wall to support the valve. The distance from the front of the stringer (2) to the front of the plaster shield is 2.8" (1). The distance from the stringer to the front of the bonnet is 3.9" (3).

Installation in fiberglass or acrylic enclosure:

Install the stringer so that the front of the plaster shield is behind the wall. The wall will be sandwiched between the plaster shield and the escutcheon.

All other installations: Install the stringer so that the front of the plaster shield is flush with the outside surface of the finished wall.

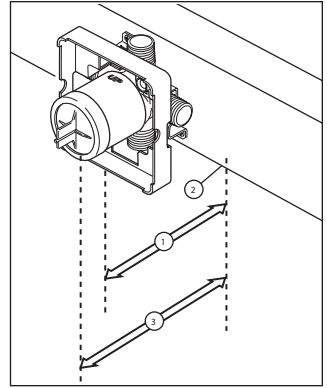

Installation

Turn off the water at the main before beginning!

Remove the cover (4) from the valve. Screw the valve body (1) to the stringer, using the two stringer mounting holes (3) on the bracket. Make sure that the word "UP" (5) is on top of the valve body.

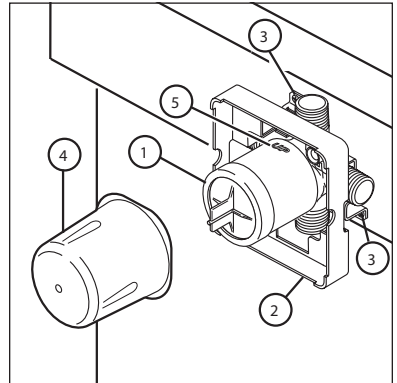

Connect the valve body to the water supplies with the proper fittings. The cold inlet (1) is on the right, and the hot inlet (2) is on the left.

If the valve is to be installed in a reverse installation (hot on the right, cold on the left), do not install the valve upside down. The cartridge (included with the trim kit) is reversible.

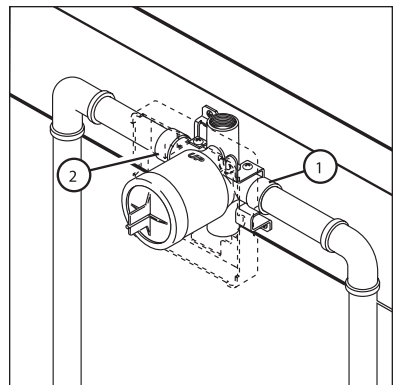

If the supply lines are to be soldered to the valve, remove the bonnet (1) and test cap (2) before soldering. Do not remove the screen (3).

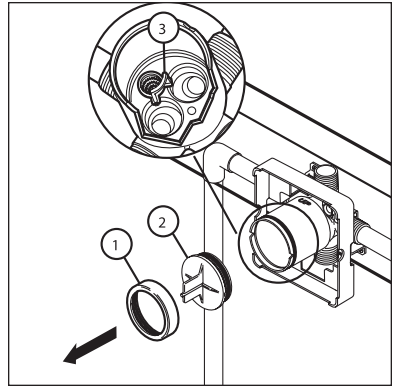

If model 06349000 (with stops) is installed, remove the stops (4).

Do not solder at high temperatures, or damage to screen will result.

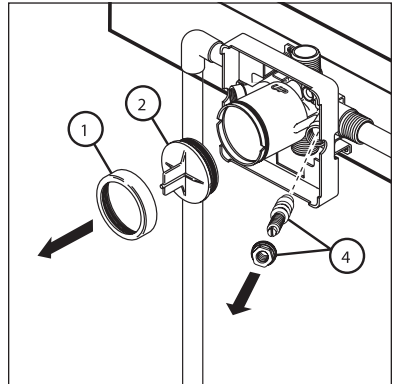

Connect the top outlet (1) to the shower pipe with the proper fittings. Connect the bottom outlet (2) to the tub spout pipe with the proper fittings. The pipe between the valve and tub spout must be $\frac{1}{2}$ " copper or iron pipe, 8" – 18" long, with only one iron pipe or copper 90° elbow to the tub spout nipple.

Do not use PEX tubing for the tub spout drop, or stacking may result.

If either of the two outlets is to be unused, seal it with a brass plug.

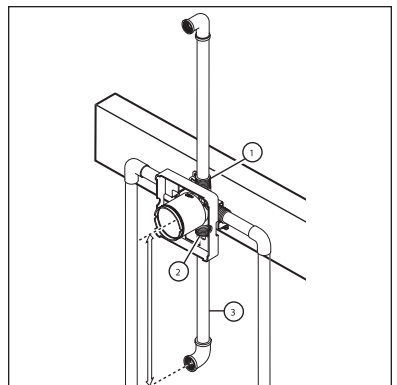

Pressure testing and flushing:

Remove the cover (1), bonnet (2), and cap (3). Make sure that the o-ring (4) and screen (5) are properly installed.

Reinstall the cap and bonnet and tighten securely.

Presurize the system – up to 200 psi for air or 300 psi for water. Check all connections for leaks.

When testing is complete, turn the water off at the main.

Remove the shower and/or the tub spout plug. Turn on the water and flush the system for at least 5 minutes.

Turn the water off at the main. Remove the filter (5). Reinstall the cap, bonnet, and cover.

Model 06349000 only: Install the stops. Turn the stops to the full open position.

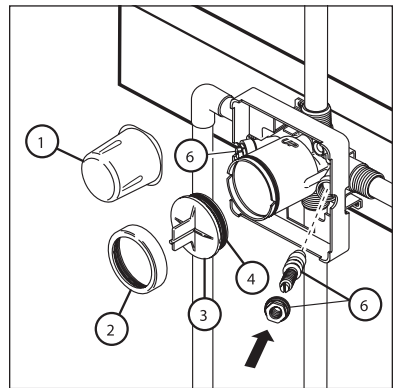
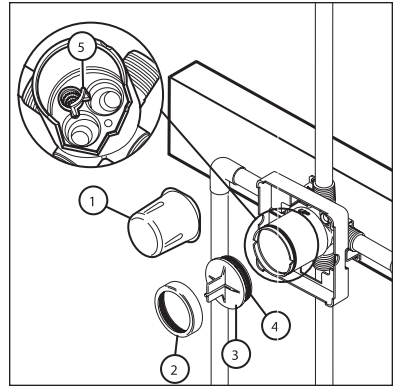

Replace the cover. Finish and seal the wall.

Commercial Trim Kit 06335000

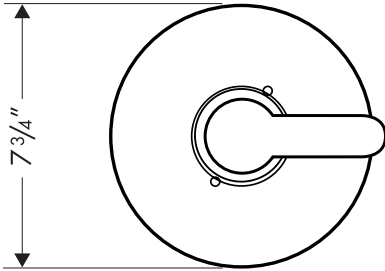

Installation

Turn the water off at the main before beginning.

Remove the cover (1), bonnet nut (2), and test cap (3), from the valve body. If the screen (5) is still present, remove it as well.

If the valve is installed in a fiberglass or acrylic enclosure, the plaster shield (4) must remain in place. In all other installations, the plaster shield may be removed, if desired.

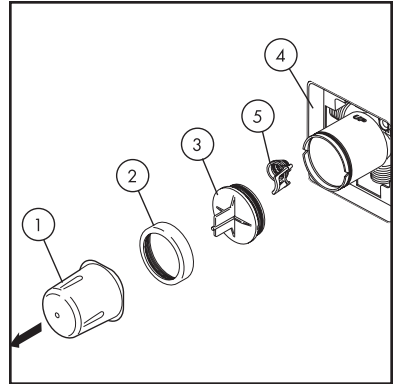

Normal installation: Insert the cartridge in the valve with the “hot side” marking on the left.

Reversed installation (cold on left/hot on right): Insert the cartridge so that the “hot side” markings are on the right.

All installations: Make sure that the cartridge engages the holes inside the valve. The keys on the sides of the cartridge should engage the slots on the sides of the valve.

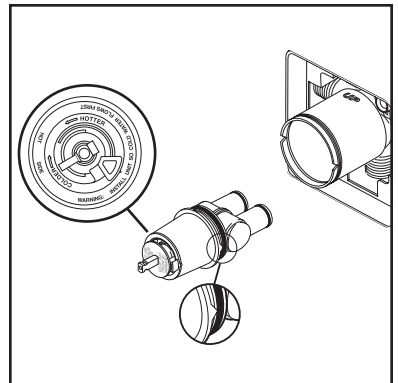

Install the bonnet nut. Tighten it hand tight.

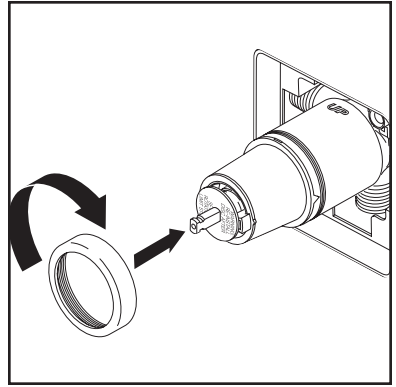

Install the o-ring on the cartridge. It should rest just behind the bonnet nut.

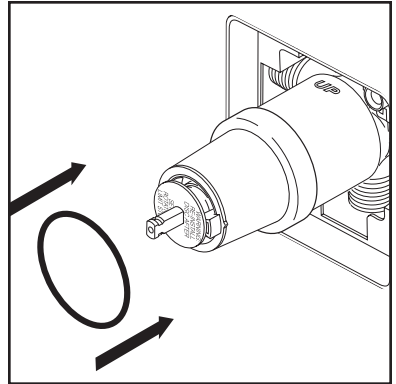

Install the spacer inside the sleeve. Push the sleeve over the cartridge, body, and o-ring.

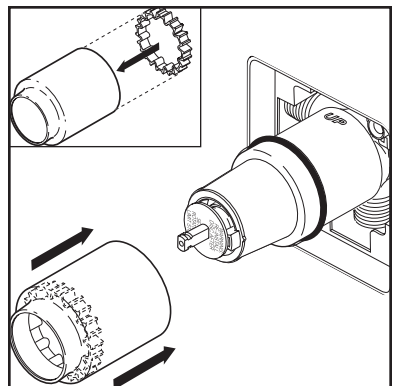

Remove the backing from the sealing tape. Press the sealing tape around the reverse of the escutcheon.



Install the escutcheon. Fasten it to the bracket with the two screws. Do not overtighten the screws.

Test the valve: Temporarily install the handle. Turn the handle clockwise until it stops. Turn the water on at the main. Begin turning the handle counter-clockwise. The cold water should come on first and become warmer the farther the handle is turned.

CAUTION: If the hot water comes on first, reverse the cartridge. See page 10 for the cartridge removal instructions.

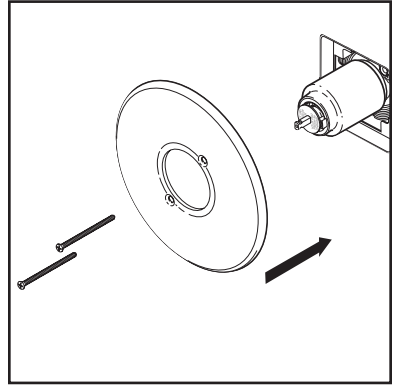

Turn the handle counter-clockwise until it stops. Measure the temperature of the output water with a thermometer. If the water is hotter than the maximum temperature permitted by code (110° - 112°F in many areas), reset the rotational limit stop (see page 9).

Install the handle. Tighten the screw with a 3mm Allen wrench.

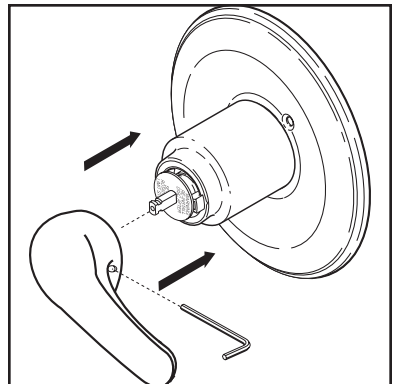

Set the Rotational Limit Stop

THE ROTATIONAL LIMIT STOP MAY NEED TO BE ADJUSTED SEASONALLY, OR IF CHANGES ARE MADE TO THE WATER HEATER.

Remove the handle. Pull the disc away from the cartridge enough so that you can grasp the rotational limit stop.

Pull out on the rotational limit stop and turn it clockwise to make the water cooler, counter-clockwise to make it warmer. The temperature change per tooth can be 4°F - 16°F, depending on the water conditions. Test. Repeat if necessary.

Push disc back into place, until fully seated. Failure to do so could result in scald injury.

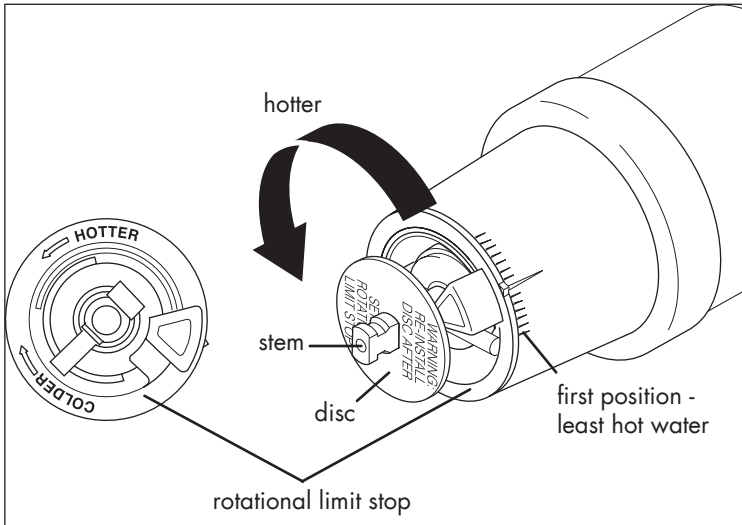

Cartridge Removal

If the cartridge must be removed for any reason, follow these steps.

CAUTION: NEVER attempt to pry the cartridge out with a screwdriver!

Turn the water off at the main.

Remove the handle and sleeve.

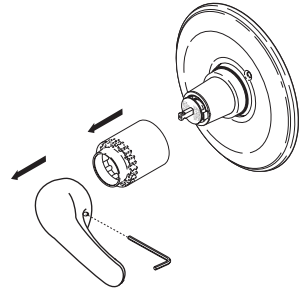

Remove the bonnet nut.

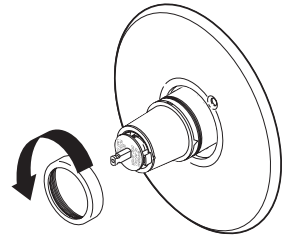

Position the handle on the stem. Turn counter-clockwise approximately 1/4 turn after the stop is contacted.

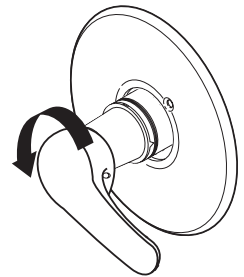

Lift the cartridge from the valve body.

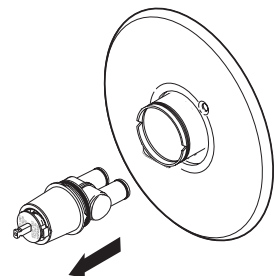

Cleaning Recommendation for Hansgrohe Products

Modern sanitary faucetry and shower fixtures consist of very different materials to comply with the needs of the market with regard to design and functionality.

To avoid damage and returns, it is necessary to consider certain points when cleaning:

Cleaning materials for faucets and shower products:

Acids are necessary ingredients of cleaning materials for removing lime. However, please pay attention to the following points when cleaning faucets and shower products:

- Use only cleaning materials intended for the application.
- Never use cleaning materials which contain hydrochloric, formic, or phosphoric, or acetic acid, as these can cause considerable damage.
- Do not mix one cleaning material with another.
- Do not use abrasives, such as cleaning powders, sponge pads, or microfiber cloths.

Cleaning Instructions for Faucets and Shower Products:

Please follow the cleaning material manufacturer's instructions. In addition, please note the following:

- Clean your faucets and shower products as and when required.
- Follow the label instructions. Do not allow any cleaner to remain on the product for longer than necessary.
- Regular cleaning will prevent scale buildup and water spotting.
- When using spray cleaners, spray first onto a sponge or cloth. Do not spray directly onto the faucet or shower product as drops could enter openings or gaps and cause damage.
- After cleaning, rinse thoroughly with clear water to remove any cleaner residue.

Important

Residues of liquid soaps, shampoos, and shower foams can also cause damage, so rinse with clean water after using.

Please note:

- If the surface is already damaged, the effect of cleaning materials will cause further damage.
- Components with damaged surfaces must be replaced, otherwise, this could cause injury.
- Damage caused by improper treatment will not be covered by our warranty.

Limited Lifetime Consumer Warranty

This product has been manufactured and tested to the highest quality standards by Hansgrohe, Inc. ("Hansgrohe"). This warranty is limited to Hansgrohe products which are purchased by a consumer in the United States after March 1, 1996, and installed in either the United States or Canada.

WHO IS COVERED BY THE WARRANTY

This warranty extends to the original consumer purchaser only. This warranty is non-transferable.

WHAT IS COVERED BY THE WARRANTY

This warranty covers only your Hansgrohe manufactured product. Hansgrohe warrants this product against defects in material or workmanship as follows: Hansgrohe will repair at no charge for parts only or, at its option, replace any product or part of the product that proves defective because of improper workmanship and/or material, under normal installation, use, service and maintenance. If Hansgrohe is unable to provide a replacement and repair is not practical or cannot be timely made, Hansgrohe may elect to refund the purchase price in exchange for the return of the product.

LENGTH OF WARRANTY

Replacement or repaired parts of products will be covered for the term of this warranty as stated in the following two sentences. If you are a consumer who purchased the product for use primarily for personal, family, or household purposes, this warranty extends for as long as you own the product and the home in which the product is originally installed. If you purchased the product for use primarily for any other purpose, including, without limitation, a commercial purpose, this warranty extends only (i) for 1 year, with respect to Hansgrohe and Commercial products, and (ii) for 5 years, with respect to AXOR products.

THIS WARRANTY DOES NOT COVER, AND HANSGROHE WILL NOT PAY FOR:

- A. Conditions, malfunctions or damage not resulting from defects in material or workmanship.
- B. Conditions, malfunctions or damage resulting from (1) normal wear and tear, improper installation, improper maintenance, misuse, abuse, negligence, accident or alteration, or (2) the use of abrasive or caustic cleaning agents or “no-rinse” cleaning products, or the use of the product in any manner contrary to the product instructions. (3) Conditions in the home such as excessive water pressure or corrosion.
- C. Labor or other expenses for the disconnection, deinstallation, or return of the product for warranty service, or for installation or reinstallation of the product (including but not limited to proper packaging and shipping costs), or for installation or reinstallation of the product.
- D. Accessories, connected materials and products, or related products not manufactured by Hansgrohe.

TO OBTAIN WARRANTY PARTS OR INFORMATION

Contact your Hansgrohe retailer, or contact Technical Service at:

Hansgrohe Inc.
1492 Bluegrass Lakes Parkway
Alpharetta GA 30004
Toll-free (800) 334-0455.

In requesting warranty service, you will need to provide

1. The sales receipt or other evidence of the date and place of purchase.
2. A description of the problem.
3. Delivery of the product or the defective part, postage prepaid and carefully packed and insured, to Hansgrohe Inc. 1492 Bluegrass Lakes Parkway, Alpharetta, Georgia 30004, Attention: Technical Service, if required by Hansgrohe.

When warranty service is completed, any repaired or replacement product or part will be returned to you postage prepaid.

EXCLUSIONS AND LIMITATIONS

REPAIR OR REPLACEMENT (OR, IN LIMITED CIRCUMSTANCES, REFUND OF THE PURCHASE PRICE) AS PROVIDED UNDER THIS WARRANTY IS THE EXCLUSIVE REMEDY OF THE PURCHASER. HANSGROHE NEITHER ASSUMES NOR AUTHORIZES ANY PERSON TO CREATE FOR IT ANY OBLIGATION OR LIABILITY IN CONNECTION WITH THIS PRODUCT.

HANSGROHE SHALL NOT BE LIABLE TO PURCHASER OR ANY PERSON FOR ANY INCIDENTAL, SPECIAL, OR CONSEQUENTIAL DAMAGES, ARISING OUT OF BREACH OF THIS WARRANTY OR ANY IMPLIED WARRANTY (INCLUDING MERCHANTABILITY).

Some States do not allow the exclusion or limitation of incidental or consequential damages, so the above limitation or exclusion may not apply to you. This warranty gives you specific legal rights, and you may have other rights which vary from State to State. You may be required by law to give us a reasonable opportunity to correct or cure any failure to comply before you can bring any action in court against us under the Magnuson-Moss Warranty Act.

PRODUCT INSTRUCTIONS AND QUESTIONS

Upon purchase or prior to installation, please carefully inspect your Hansgrohe product for any damage or visible defect. Prior to installing, always carefully study the enclosed instructions on the proper installation and the care and maintenance of the product. If you have questions at any time about the use, installation, or performance of your Hansgrohe product, or this warranty, please call or write to us or call us toll-free at 800 334 0455.

hansgrohe

Hansgrohe, Inc. • 1490 Bluegrass Lakes Parkway • Alpharetta, GA 30004
Tel. 770 360-9880 • Fax 770 360 9887

www.hansgrohe-USA.com